

WAHLUKE

WAHLUKE (GRANT COUNTY)

Est. as Julia (Yakima County) 5/5/1904

Julia was named for Julia Craig (Byrd), daughter of the first postmaster, Edwin W. Craig.

On July 26, 1905, the area became Benton County (newly established from Yakima and Klickitat Counties).

On November 8, 1907, the name was changed to WHITE BLUFFS, but was changed back to JULIA on December 6, 1907, less than a month later.

JULIA was then moved across the Columbia River into Douglas County and on December 18, 1907, the name was changed to WAHLUKE. (I have not definitely established source of name Wahluke.)

The State Legislature of 1909 created GRANT COUNTY from the southern part of Douglas County, and Wahluke was included within the newly created county.

It is interesting to note that a new town of WHITE BLUFFS was established on December 18, 1907--the same day that the first White Bluffs was changed back to Julia. The two White Bluffs were about six miles apart.

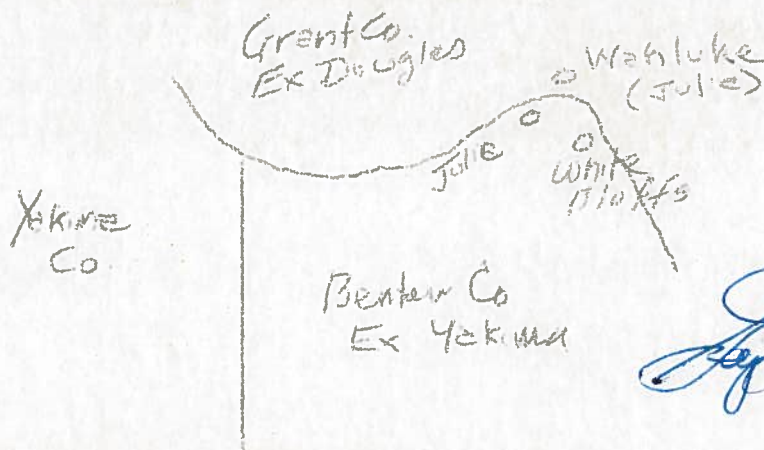

PRIEST RAPIDS

PRIEST RAPIDS (YAKIMA COUNTY)

Est. August 9, 1913

POSTMASTERS:

Louis W. Ragsdale	8/9/13
Frederick E. Reynolds	2/24/15
Ellen D. McGinnis	8/21/18
Edward B. Alexander	12/7/18
Gertrude S. Dregner	2/18/21
Harry Blockler	2/5/23
Edgar B. Sanford	12/12/24
Floy Yober	3/16/28
Lula Johnson	4/30/29
Alsey B. Gurn	1/1/30*
Mrs. Halcie O. Dwin	1/4/30

Discontinued 4/30/37

*Acting postmaster actually served from 1/1/30 to 1/15/30.

Mail Service via C.M. & St. P. Ry

Lyman

Citations:

Click Relander, 1212 N. 32nd
Ave. Yakima

Dalles City Directory for the Year 1883

T.H. Ward & Co. Compilers and Publishers. The Dalles, Oregon,
published at the Wasco County Sun Printing House, 1883

p. 27 Horses.

The people of all this region show a keen love for a good horse and are taking great pains to introduce improved strains of horse blood. Knox, Norwich, Hambletonian, Lindsey, Pathfinder and other good breeds, are to be found scattered over this and Crook county. And we learn that arrangements are being made to bring representative animals of several popular breeds from the East as soon as rail connections are completed. The number of horses, according to the Assessor's returns, are 25,616, value \$1,280,000.

Klickitat County..War As early as 1852 an Army officer named Jordan fenced in many acres across from Fort Dalles and several men located along the river

In 1852 E.S. Joslyn located at what is now Bingen and established his home, set out orchard and cultivated tract of land. He returned after war and lived there till 1874

Cattlemen..

In 1859 territorial legislature formed the county, named "Clickitat" located the county seat at Rockland across from the Dalles and appointed officers.

Historical: Cleveland:

Settled by Ripley Dodge who came from Cleveland, Ohio.

Settled in 1879, opened a hotel and later platting a town called
Dodgetown, changed to Cleveland

By 1880 S. Lowenberg constructed a store and established first po.

Fire destroyed the business area in 1896, but town recovered

Cleveland Roller Mills contributed to economy

School District 30 organized in 1882 with Mrs. Sadie Murphy as the
school's first teacher. Si years later building erected to accommodate
50 students

In 1884 First Presbyterian Church founded and the Rev. William
Douglas was minister in 1904, also preached at Bickleton and Dot. His son
was Chief Justice William O. Douglas .

Early days at Cleveland Mill, Dodge

Van Nostern, store

Mrs. Varner, home

Courtney

Dancehall

Zumwalt, Jenkins, a jewelry store

In 1890 town had a drug store, two general stores, two hotels,
livery stable, grist mill.

Entire business section burned in 1896 and was rebuilt but town
declined as Bickleton grew

Cleodell postoffice came into being in 1922

Tri weekly stage service in ~~1880~~ 1903.

2--

Cleveland historical

-----In 1881 Sol Lowenberg at Goldendale looked at Wood Gulch on wagon road from Goldendale and Dot. Built store on homestead of Ripley Dodge, postoffice named Dodgetown

In 1883 Ripley Dodge surveyed a townsite and platted it. Ripley Dodge named his town Cleveland, honor of his home city.

In 1882 Lowenberg sold out to James L. Chamberlain, who was postmaster, remained only a few months before selling and moving to Prosser.

David Mason, drugstore. George Merton, general store.

Archibald Dodge, general store. J.J. Purviance, furniture store.

Ripley Dodge, hotel. W.A. McCredy, hotel and livery barn. Charles McClain, blacksmith shop.

In 1890 Henry C. Mackley built a grist mill.

In 1896 the entire business district of Cleveland wiped out by fire which started at daybreak in livery barn

~~On Dodge road, Dodge road, Dodge road~~ Destroyed were general store, two blacksmith shops, furniture store, livery barn, warehouse and dance hall. Houses isolated, did not burn.

Town rebuilt. Bickleton grew. By 1915 decline

Alder Creek Pioneer association is biggest prosperity.

Charles N. Pickle arrived on the Bickleton plateau in May, 1879 two miles south of Alder Creek where Robert M. Graham and others had settled

North Bank railroad built in 1905-7 and then Alderdale, Roosevelt, Sundale, Sixprong and Blue Light ~~added~~ were started.

Bickleton wiped out by fire in 1887, all building except one blacksmith shop and two dwellings destroyed.

Sheep in earliest days, most of 150,000 in eastern Klickitat county

1879--Ephram McPharland started a sawmill in timber bordering pine Creek, west of Bickleton. soon Dave Sprinkle started mill further back in timber.

Richard M. Buckley started a third sawmill in woods northwest of Cleveland.

Charles N Bickle bought first lumber from Mc Parland to erect store and home which started town of Bickleton.

California immigrations, Russia, Danes, Matsens, Jensens colony of 12 to 15 families Danish families Swiss descent.

Until about 1881 all grain sown was cut for Hay. 1881 new seed wheat obtained from Wa Wa, first threshing by C.N. Newell grain hauled to the Coyle boat landing and shipped boat to PD. farmers got 75 cents to 1 a bushel for sacked grain. Farmers paid 1 to 1.50 a sack for flour after shipped from PD.

Arrival of ry in 1884-185 taken to 20 Mabton NP
When SP and S ry was built in 1905-7, warehouses were built at Sundale, Roosevelt and Alderdale
in 1903, thresh machine sack meters showed a yield of 500,000 bushels of milling wheat from the Bickleton Plateau, within a radius of 10 miles of town.

Excelsior Lodge No. 111, IOOF instituted at Bickleton Jan 1, 1892 with 18 charter members. Charles N. Bickle, first noble grand.

The Onepennie family came from this region, George Gibson, and from Rock Creek William Yallup, a descendant of several treaty signer chief bloodlines, his son, Thomas K. Yallup were of Rock Creek where Gus George lived

In April, 1878 Weekly Pacific Tribune--Goldendale in Klickitat County has taken a spurt at growing and of course must have its newspaper. Eugene Campbell of Hillsboro, Ore has gone there for the purpose of gratifying his desire and soon we may look for the appearance of the 24th living newspaper claiming an origin and home in Washington territory. Goldendale, by the way, we consider the most promising small town in the territory, for the year anyway. The population will double in 1878. A photograph gallery, a barber shop, a drug store, furniture store, live y stable, new hotel, cigar stand and now a newspaper will be among a few of the business enterprises of the last half of the year.

And in 1891-Goldendale which has not had a saloon for about ten years has just passed an ordinance permitting them to exist and providing a license of \$700 per annum. It is claimed that Mayor Bonebrake will veto the ordinance and that it cannot be passed over his head. Yakima Herald, January 22, 1891.

Historical 2

Wheat 30 bushels to the acre, 50 is good.

Harvest, just after July 4th

In 1950 the new Mabton grade was completed, guard rails, oiled
Walking plows first, then riding plows for sissies. (Now look at you)

A.J.Spoon the FIRST president

Hocket bearing an American flag fired. (as was the custom in 1959)
president and wife riding in a buggy

Origin: It was proposed March 3, 1911 at a meeting of the
County Farmers Union in Dot.

Then known as Pioneer Day

A.J.Spoon first president. E.Y. Stove vice president. R.H.Buckley, secy.

Grounds donated by W.A. McCredy, George Varner and George Robins.

Blue Light, community at head of Tule Canyon

Historical: Western end of Horse Heaven wheat land

1948-George Davis of Sunnyside, said father, the late James Davis was one of the original African Dodgers. Expert at ducking. Pioneers pitched eggs at him.

William Simons of Portland (48) who helped build Bickleton church, settled there in 1897 (church and school)

Will Bickle of Granger, 75, named for father, Charles N. Bickle.

Bickle family arrived in 1878, store, sold to cowboys and Indians, before wheat.

Bickle family came from Kansas. Operated a store at Goldendale first for a year.

Bickle paid for mail from Goldendale to Bickleton first three years. Mail trip made once a week in 1900

Arrival of Robert Graham and his two brothers in law and their families arrived in 1872

Year of heavy migration to Bickleton was 1878, 1879 and 1880

A year later Cleveland was settled. Then areas south of Cleveland and Bickleton, finally east and northeast of Bickleton

Had pioneering spirit, a cooperative spirit, more so than today

Pasco, Goldendale and Columbia River Railroad formed late in 1890 to provide transportation to Cleveland. Then population of 500
Never materialized

Barge traffic good for area in 1952, better now

Good road along the Columbia has jobs that did not exist then has come to pass

Klickitat Ditch, never materialized. (Now John Day Dam, Umatilla pool and irrigation.)

Dream of unlimited water on the Horse Heaven is not so far off

Moses Lake

Adam Harley East, 85 years old, died in 1957 and 1956 at Soap Lake. Moved to Moses Lake in 1950. Museum at Balsam and Fifth ave .

Seap P20 Lake, 50 years old in 1957.

Fishes, 12 species. Most prevalent the yellow perch, bluegill , largemouth bass, small mouth bass and black crappie. Carp largest.

Carp began appearing after flood of 1903-4.

Carp fishing, 1916, Clarence and Walter Schneirla for Jewish holidays. Shipped five carloads to east, grossed \$29,000 but went out of biz. Averaged 12 pounds.

I.N. McGrath of Ninnewash fish co operated from 1918-28 shipped 80 carloads east. Retaining ponds various arms of lake. Iced.

EngObedO

Moses Lake

Post office named Moses Lake April 16, 1906.

Mae po four miles west of Moses Lake, named May 1, 1907 in honor of Mrs. Mae Shoemaker, first postmaster.

Douglas County, Nov 28, 1883, for Stephen D. Douglas. Lincoln County had been created four days earlier.

Burke, were American Germans from Allose, Minn. Called Alloseze in 1907, named for James M. Burke PM honored by petition for name change

Palisades on Great northern in Southern Douglas county in 1906, formerly called Mix Beulah Land.

Moses X Coulee, 15 miles west of Grand Coulee, a twin inacial origin.

Moses Rock, a mile swest of crossing of Rockyford Creek by Ephrata Moses Lake highway on old Drumheller sheep ranch. Granite, raft ice.

Rock was called Un Ta Pas Neat, Rock on a Hillside. Montana Indians camped on east bank of Rockyford. By 1953 the lake had backed up almost to Rock.

Lake created by primitive impounding of waters, shifting of pot oles dunes and timbered repairs of breaks.

At. Arnold of ry survey noted it in 1853, Nov. 20 on Hudson's Day Trail, black butte near Adrian. Six miles long and mile wide

Original Moses Lake a po was on a rise a mile to the southwest of Neppel the origin of settlement here

Moses Lake, early history

First settlers moved in and planted orchards around lake.

Neppel grew under Grant Realty Co., a ~~subsidiary~~ subsidiary of the Milwaukee Land and Townsite Co.

Cross state highway in 30s helped grow.

Postmaster Loren E. Harris retired in 1956.

He came to the basin in 1910, Ephrata, to manage the Morris Hotel, Ephrata, then a town of 350 persons, 10 inches of dust.

In 1922 Harris bought Grant Hotel at Moses Lake, ~~named~~ named it the Moses Lake Inn. It burned in 1939. 1923 named p. Served 99 units including biz district. Al Harris, no relation, was former PM and operated PO in Central School since 1912.

After Hotel burned Harris built 16 x 18 "shack, Broadway and Ash. By 1942 it becoming too small. One day 52 sacks of ail for Larson Air Force Base. Been four sacks. In 1948 PO moved to Division 1

Moses Lake..

Hiwatha Valley, in 1913, pump for irrigation, opening of Chicago and Milwaukee and Puget Sound Ry from Warden to Neppel, the original name for the community. Neppel was located on the east shore of the lake.

J.R. Snyder.

A.C. Grossman of Wenatchee, 200 acres of orchard, trees watered by wells, lift of 30 from one, 75 feet from the other. Experimenting with fruit, grain and vegetables, 36 bushels of corn to the acre. Alfalfa, four cuttings.

1913 the Neppel commercial club, boosting, 30,000 acres of irrigable land around shores of lake by pumping and from the lake.

Moses Lake 16 miles long and a mile to a quarter wide in 1913, average area of 10 to 30 feet deep.

Neppel at the neck of peninsula between two arms of the lake, east shore. Freight barge and launches, dock, 3 story hotel, water system, telephone, lights.

On March 13 that year, 1913, choice of lots at auction, one third down, one third in year, one third in three. On March 17, the best farm tracts near town sold for \$150 an acre.

Col. Basin water available in 1952, sugar beets first planted on commercial scale in 1949 when water was pumped from Moses Lake or from wells.

Moses--Place names. Place where sister is buried on mouth of Moses
Coulee overlooking Columbia was old Mallotte ferry, overlooked. Called
Quillickchin or Quillicht. One half mile below Cabinet Rapids.

Falises, name Cathla Kathlalwish, or Boushdd brushy or timber place, or trees on a flat.

Billy Curlew, head man after his death, a descendant of Moses.

Moses was a son of one of three chiefs of the whole NW called
Tittalch cum or half sun.

Senzentogh, later his wife, ruled home when Moses was the chief was
on buffalo trips.

Moses died in 1899 at Colville. is buried in Chief Moses
Recreation Cemetery with wife, had one wife at time of death, Mary
Moses of Santhlalo who lived to be 108 years old.

~~Name for Col river was En pu quat tool (Enehewana, or Wana)~~

~~Ephrata, a summer camp, called En Tach Ha Num (like willow place)~~

~~Name for themselves was Kawachchin, or called themselves Papsspan.~~

~~Kawachchin also name for a rock on mt. at Rock Island, hole
there, it was guard place to watch for Indians coming from downstream
to raid, it was on the right bank of the Columbia.~~

Moses Lake. *Moses*

Moses Lake, old barbed wire fence, ran from Parker Horn of
Moses Lake to Pelican Horn, at point close to Division st.

Land enclosed by fence and water to pasture Indian ponies.

Winter of 1903-4 flood, blow sand dammed water, took out,
emptied into Columbia at Beverly.

Caused descendants of Chief Moses to move to ~~down~~ the N.E.

Tom McMannon place south of O'Sullivan Lake for their spring gathering.

Moses Coule

Moses Lake

Moses Lake (city)

Chief Moses Jr. High School, named in 1954. City incorporated
in 1938.

1849
70

1829

The lands his people ranged on Douglas and Grant and Kittitas counties, Wenatchee Valley and Entiat section of Chelan County.

They were the middle people, fisheries at rock island rapids.

Others had reservation, they had this range of land, no treaty....

Range horses, winter, from Moses Lake south to Snake River.

Chief Wolf. Gardened in the Palisades of Moses Culee.

Rocky Ford where Rocky Ford Creek empties into Moses Lake was and spring gathering place and summer.

Homeless, landless through 60s and 70s.

A reservation was created for them by executive order of President Hayes on April 19, 1879, the Columbia or Moses Reservation.

On west side of Columbia and Okanogan River. But that was reopened to white settlement in May, 1886 and Moses and band were moved to Colville Reservation.

He died at Nespelem March 1899 70 years old.

Morgan, champion driver between Portland and Oakland.

Stage line from The Dalles to Ellensburg was a continuation of the Central Pacific Ry at Kelton, Utah with the Dalles, Pendleton, Walla Walla, ~~Colfax~~ Colfax, Lewiston and Pomeroy by stage.

Large lot of co. 22 stages, 30 horses and 100 150 stablemen. x n and drivers.

By 1870--road from The Dalles to Yakima City completed and stages making daily trips, before them over Military Road.

By 1877 a daily trip from the Dalles to Coldendale.

Two years later extended to Ellensburg from Yakima City.

From Coldendale to Yakima the stage made daily trips. Yakima to Ellensburg ran only three times a week.

In 1880 Thomas Johnson established a line and a trip made every other day. Five passengers including driver.

Two horses used on high stage. Stage barn in Wenatchee. Once there, none on south trip. Up enough.

80s..Meritt Damman, Yakima City Ens.

Billy Mills, Kittitas. Tom Kelly.

NOT much profit changed often.

Stage from Yak left for Ellensburg before daylight, got in at dark.

Even, Fair, Yak, Fare Ellensburg \$5 50 miles; Ellensburg Pasco 125 miles \$15; the Dalles \$150, fare \$15

Roads, dustworst than mud, hub deep, making it next to impossible to do hauling or travel in a light rig.

J.C. Oliphant, zillah, attn to farmers that sage brush, burning everywhere, is badly needed on the road.

1907--macadamizing .the city and Old Town, May, 1907.

April--I.H. Dills and other businessmen.. April 13, 1904.. below gap, road so bad buggies mired down. People in valley buying goods inound and shipping them to Wapato.

Ira Crofutt finished strawing the main road from Prosser to Horse Heaven.. Received \$126 from Prosser businessmen, hauled 65 loads of straw at \$1.20 a load : Prosser, Sept. 30, 1902.

Klickitat co. 1868--meeting, county pioneer county

road, up to that time there had been no effort made as county.. few roads constructed by individuals or government.

Jonathan (Jock-Morgan, 1861 (?) six horse teams, careening stage, strapped in

thoroughbrace stage coaches, leather straps bound together acting as springs.

Canyon Road.

Freight rates The Dalles to Yakima City 2 cents a ~~1000~~ pound.

To Ft. Simcoe cent and one-half, several steep hills, 12 to 14 miles steep, 2,000 to 2,500 pounds a good load for four horses, req six days. Simcoe To Dalles 110 miles Canyon Road/ 50 to 70 four horse teams Indians.

A.H. Lillie, license to trade, 1881 (Com;aint of the Sattastrading p st, warned by James H Wilbur..

I hear rumors of complai t about yourha i trading p s t.

Lillie stage station on Satus, 82.

W.S. Mills of Nob Hill, hauled for Shoudy & Steward, "llensburg in 1879, four o r six horse team, bobsled sometimes, eight years.